

Drywall Z-Furring Channel

1-1/2" depth x 18mils (25gauge)

Z-Furring channels are an ideal product for furring out the interior walls on an existing masonry or new concrete / masonry walls. It is especially useful when insulation is required on the interior side of a masonry wall.

Product Data & Ordering Information:

Material: All Material: Grade 33ksi min. yield strength, G40
18mils: 25 Gauge, 0.0188" Design Thickness, 0.0179" Min. Thickness

Dimensions: 3/4" leg x 1-1/4" leg x 1-1/2" deep
Stock Lengths: 10'-0" long
Packaging: (10) pieces per bundle – (320) pieces per pallet
Packaging weight: 22 lbs./bundle or 214 lbs./1000 ft.

ASTM & Code Standards:

- AISI North American Specification [NASPEC] 2001 Supplement
- Furring channel is produced to meet or exceed ASTM C645
- Galvanized sheet steel meets or exceeds requirements of ASTM A924 & A1003
- For installation & storage information refer to ASTM C754
- MSDS & Product Certification Information available at www.clarkdietrich.com

Related Accessories:

- Other profile depths available: 1", 1-1/2", 2", 2-1/2" and 3"
- 7/8" and 1-1/2" Furring / Hat Channel
- Single and Double Leg Resilient Channel

09.22.16 (Non-Structural Metal Framing)

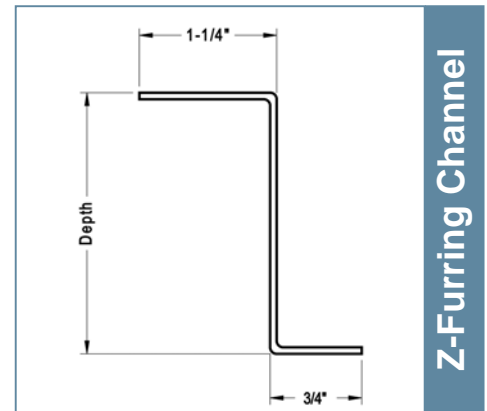

- Furring for masonry walls
- Allows for rigid insulation

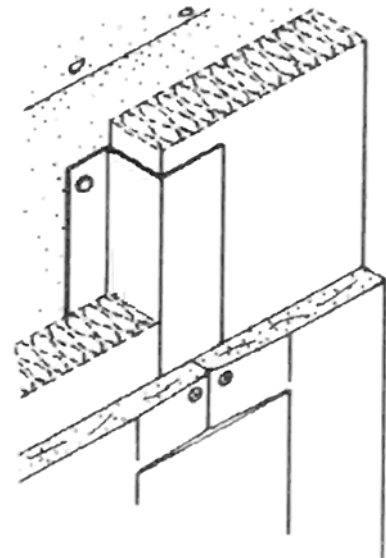

GREEN Benefits and Recycled Content:

LEED Credit MR 2 - ClarkDietrich products are manufactured from cold-formed steel. Steel is 100% recyclable, which helps divert debris from the waste stream. The contribution to LEED must be calculated by the contractor based on weight or volume.

LEED Credit MR 4 - ClarkDietrich's steel products have a minimum recycled content of 34.9%, of which 24.3% is post-consumer, and 9.4% is pre-consumer. To report a higher number for your project or seek Credit MR 5, contact Technical Services at 888-437-3244 or visit www.clarkdietrich.com.

CD-150DZF-18 © 04/11 ClarkDietrich Building Systems

Project Information

Name: cavobuilderssupplies.com
Address:

Contractor Information

Name:
Contact:
Phone:
Fax:

Architect Information

Name:
Contact:
Phone:
Fax: