

Product category: S162 (1-5/8" Flange Structural Stud)
Product name: **362S162-54 (50ksi, CP60) - Punched**
54mils (16ga) Finish: CP60 per ASTM C955
Color coding: Green

Geometric Properties

Web depth	3.625 in		
Flange width	1.625 in	Punchout width	1.50 in
Stiffening lip	0.500 in	Punchout length	4.00 in
Design thickness	0.0566 in	Min. steel thickness	0.0538 in
Yield strength, Fy	50 ksi	Fy with Cold-Work, Fya	50.0 ksi
Ultimate, Fu	65.0 ksi		

Gross Section Properties of Full Section, Strong Axis

Cross sectional area (A)	0.422 in ²
Member weight per foot of length	1.44 lb/ft
Moment of inertia (Ix)	0.873 in ⁴
Section modulus (Sx)	0.482 in ³
Radius of gyration (Rx)	1.438 in
Gross moment of inertia (Iy)	0.154 in ⁴
Gross radius of gyration (Ry)	0.605 in

Effective Section Properties, Strong Axis

Effective Area (Ae)	0.296 in ²
Moment of inertia for deflection (Ix)	0.873 in ⁴
Section modulus (Sx)	0.444 in ³
Allowable bending moment (Ma)	13.28 in-k
Allowable moment based on distortion buckling (Mad)	13.60 in-k
Allowable shear force in web (solid section)	3372 lb
Allowable shear force in web (perforated section)	1016 lb
Unbraced length (Lu)	34.4 in

Torsional Properties

St. Venant torsion constant (J x 1000)	0.451 in ⁴
Warping constant (Cw)	0.457 in ⁶
Distance from shear center to neutral axis (Xo)	-1.283 in
Distance between shear center and web centerline (m)	0.774 in
Radii of gyration (Ro)	2.020 in
Torsional flexural constant (Beta)	0.597

ASTM & Code Standards:

- AISI North American Specification [NASPEC] S100-07 with 2010 supplement
- * Effective properties incorporate the strength increase from the cold work of forming
- Gross properties are based on the cross section away from the punchouts
- Structural framing is produced to meet or exceed ASTM C955, A653 and A1003
- Galvanized sheet steel meets or exceeds requirements of ASTM A924
- ClarkDietrich's structural and nonstructural framing comply with the SFIA Code Compliance Certification Program and ICC-ES ESR-1166P
- For installation & storage information refer to ASTM C1007
- MSDS & Product Certification Information is available at www.clarkdietrich.com

GREEN Benefits and Recycled Content:

LEED Credit MR 2 - ClarkDietrich products are manufactured from cold-formed steel. Steel is 100% recyclable, which helps divert debris from the waste stream. The contribution to LEED must be calculated by the contractor based on weight or volume.

LEED Credit MR 4 - ClarkDietrich's steel products have a minimum recycled content of 34.9%, of which 24.3% is post-consumer, and 9.4% is pre-consumer. To report a higher number for your project or seek Credit MR 5, contact Technical Services at 888-437-3244 or visit www.clarkdietrich.com.

05.40.00 (Cold-Formed Metal Framing)

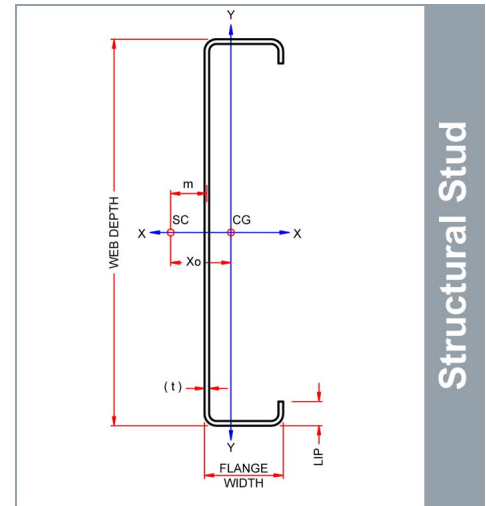

Structural Stud

Used in framing applications:

- Load-bearing walls
- Curtain walls
- Tall interior walls
- Floor & ceiling joists
- Trusses

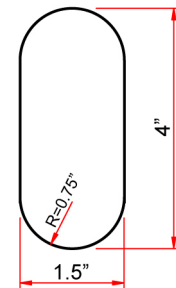

Structural Punchout

East market punchout spacing:
12" from lead end then 24" o.c.

West market punchout spacing:
24" from lead end then 24" o.c.

Project Information

Name: cavobuilderssupplies.com
Address:

Contractor Information

Name:
Contact:
Phone:
Fax:

Architect Information

Name:
Contact:
Phone:
Fax: